



DILTON MARSH

Flower & Handicraft Show

Saturday 26th July 2025

Dilton Memorial Hall

2pm

Doors open
for public viewing

3pm

Prize giving followed
by auction of produce



diltonmarshflowershow@gmail.com

DILTON MARSH FLOWER AND HANDICRAFT SHOW 2025

Welcome to the Dilton Marsh 2025 Flower and Handicraft Show.

When the show opens its doors, the audience are always excited to see what has been produced, so we encourage you to enter, using the form at the back of this booklet.

All entries are anonymous, so don't be shy! There are categories to suit all ages, all skills and all creativity.

Good luck with whatever class/es you enter – your efforts are always appreciated.

Do put the date in your diary and join us for a great afternoon; refreshments are available, and you get a chance to catch up with your local community.

Thank you to everyone who makes the village show successful: all our entrants, along with our generous sponsors – it couldn't happen without you.



JOHN IRVING CUP: Awarded for the most points gained in the fruit and vegetable classes.

MEAD NURSERY CUP: Awarded for the most points gained in the flowers and floral art classes.

JOAN BRACKEN CUP: Awarded for the most points gained in the cookery classes.

IRIS HARES CUP: Awarded for the most points gained in the handicraft classes.

DILTON PHOTOGRAPHY CUP: Awarded for the most points in the photography classes.

W.I. CHALLENGE PLATE: Awarded to the winner of the group display.

CHARLOTTE BOLWELL MEMORIAL AWARD: Awarded for the most points in the children's classes.

DILTON AMATEUR GARDENING CLUB CUP: Awarded for the winner of the most points overall.

Thank you to all our sponsors, supporters and participants!

The Dilton Marsh Flower & Handicraft Show has been running since 2009. The show continues to take place annually because of the local people, businesses and the Parish Council who support it.



Dilton Marsh Parish Council

Email: clerk@office.diltonmarshparishcouncil.gov.uk
www.diltonmarshparishcouncil.gov.uk

Valletta Surfacing Limited

Driveway and path construction
Clivey, Standerwick 01373 823827

www.vallettasurfacing.co.uk





Clearwood Boarding Cattery

17 Clearwood, Dilton Marsh BA13 4BD

01373 864544 or 07749 421829

www.clearwoodcattery.co.uk

Home Fix Heating Services

Plumbing services

07748 581003

Email: homefixheating@gmail.com



Butterfly Studio

Handmade memory bears, fabric accessories and gift items

Etsy: [ButterflyStudiobyKL](https://www.etsy.com/shop/ButterflyStudiobyKL)

Instagram: [butterflystudiouk](https://www.instagram.com/butterflystudiouk)

Tim McCarthy

Painting, decorating, general maintenance

01373 461553

E.G. Martin Limited

Central heating oil

01373 822784

Martins Estate Agents

7 Palomino Place

Westbury

BA13 3SD

01373 866686

Email: westbury@martinco.com

A huge thank you to all our sponsors!

NEEDL Designs

Handmade wooden items + downloadable digital cut & print files

Please visit: [NEEDLdesigns.etsy.com](https://www.etsy.com/shop/NEEDLdesigns)



KT Sports Massage

Sports massage therapy in Westbury

kthuddspmassage@gmail.com

White Horse Windows Limited

Windows, doors, conservatories and more ...

Westbury Leigh

01373 302594

www.whitehorsewindows.com

Mrs G Accounting Services Ltd

Book keeping, Self Assessment Help, Quickbooks, VAT
15 Tower Hill, Dilton Marsh BA13 3SP
01373 822461 or 07815 525662

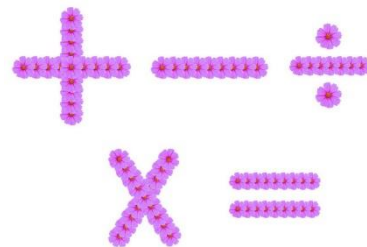

Whitefield Car Parts - Auto parts and supply
18 Clivey, Dilton Marsh BA13 4BA
07774 293713 www.carparts wiltshire.co.uk

Keratex - The Hoofcare Experts

Fairwood Road, Dilton Marsh
01373 827649 www.keratex.com



Dilton Motors

MOTs, servicing, repairs and sales
85 High St, Dilton Marsh
01373 822217
www.facebook.com/diltonmotors

Andrew & Helen Jones
and other generous
individuals

Beautopia - Hairdresser

contact Vicki, St Mary's Lane, Dilton Marsh
07540 366948



New Dilton Fish & Chips - OAP deals
85 High Street, Dilton Marsh
07761 681201

H2O Plumbing and Heating services

Andy Ridler, Chapmanslade 07886 114654



Beauty at Home

Beauty Salon
Petticoat Lane
Dilton Marsh
Keri 07912 877202



Chalcot Park
Caravan storage
& campsite
Hisomley
BA13 4DE
01373 832309

Chris Vaughan
Builder
07967 580702



2025 CLASSES

VEGETABLES and FRUIT

Where marked with a *, items should be uniform in size.

- | | |
|--------------------------------------|---|
| 1. Herbs | A single bunch of 4 varieties tied & labelled |
| 2. Broad Beans* | 5 |
| 3. Courgettes* | 3 |
| 4. Chard | 7 – mixed variety |
| 5. Lettuce | 1 – any variety |
| 6. Potatoes* | 5 – any variety |
| 7. Shallots | 5 |
| 8. Tomatoes* | 5 - any variety |
| 9. Windowsill microgreens | A small container of |
| 10. A display of seasonal vegetables | |
| 11. Gooseberries | 9 – with stalks and calyces |
| 12. Plums/Gages | 9 – with stalks |
| 13. Rhubarb* | 3 – with heel |
| 14. A display of seasonal fruit | |

FLOWERS

- | | |
|--------------------------|--------------------------------------|
| 15. Rose | 1 specimen judged for perfection |
| 16. Garden flowers | 5 stems, all different, in a vase |
| 17. Gladioli | 3 spikes, in a vase |
| 18. Sweet peas | 7 stems, mixed colours, annuals only |
| 19. Flowering shrubs | A mixed display, in a vase |
| 20. A potted succulent/s | |

FLORAL ART

21. Arrangement in a teacup and saucer
22. Miniature arrangement - no more than 4" in any direction
23. A table centrepiece using fresh or dried materials
24. A dried flower display in a terracotta pot

COOKERY and PRESERVES

25. Victoria sandwich – using the following recipe: ideally in a 7" tin: 3 eggs, raspberry jam, caster sugar dusting. An 8" tin: please alter your recipe to suit and use 4 eggs.
26. Dorset Apple Cake – using the following recipe: 115g unsalted butter, 225g self-raising flour, 2tsp ground cinnamon, 115g light brown sugar, 1 large egg, 8tbsp milk, 225g Bramley or Granny Smith apples, 100g sultanas, 2tbsp demerara sugar. *Full instructions on BBC Good Food, Dorset Apple cake, Edd Kimber.*



DILTON MARSH
Flower &
Handicraft Show

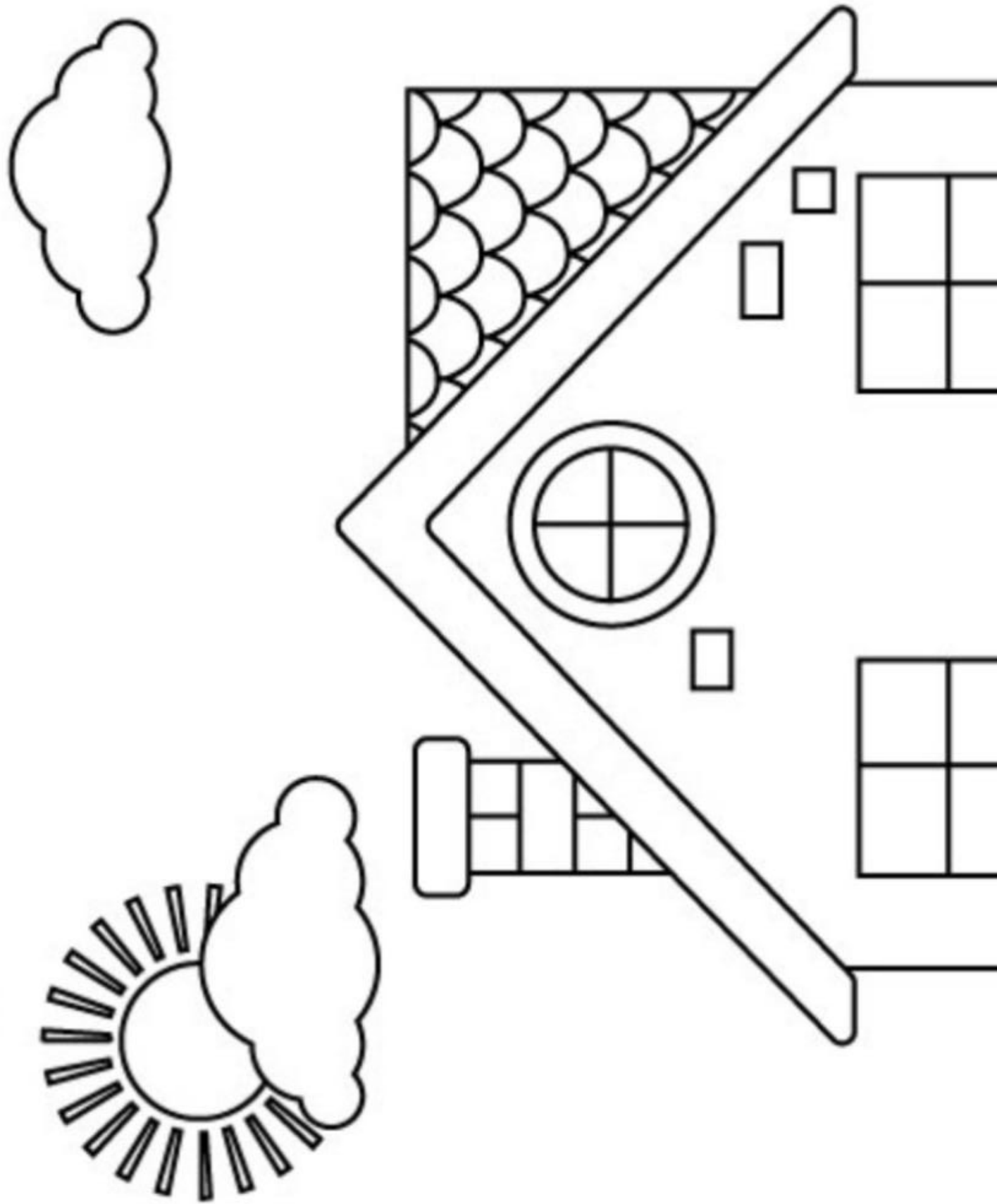

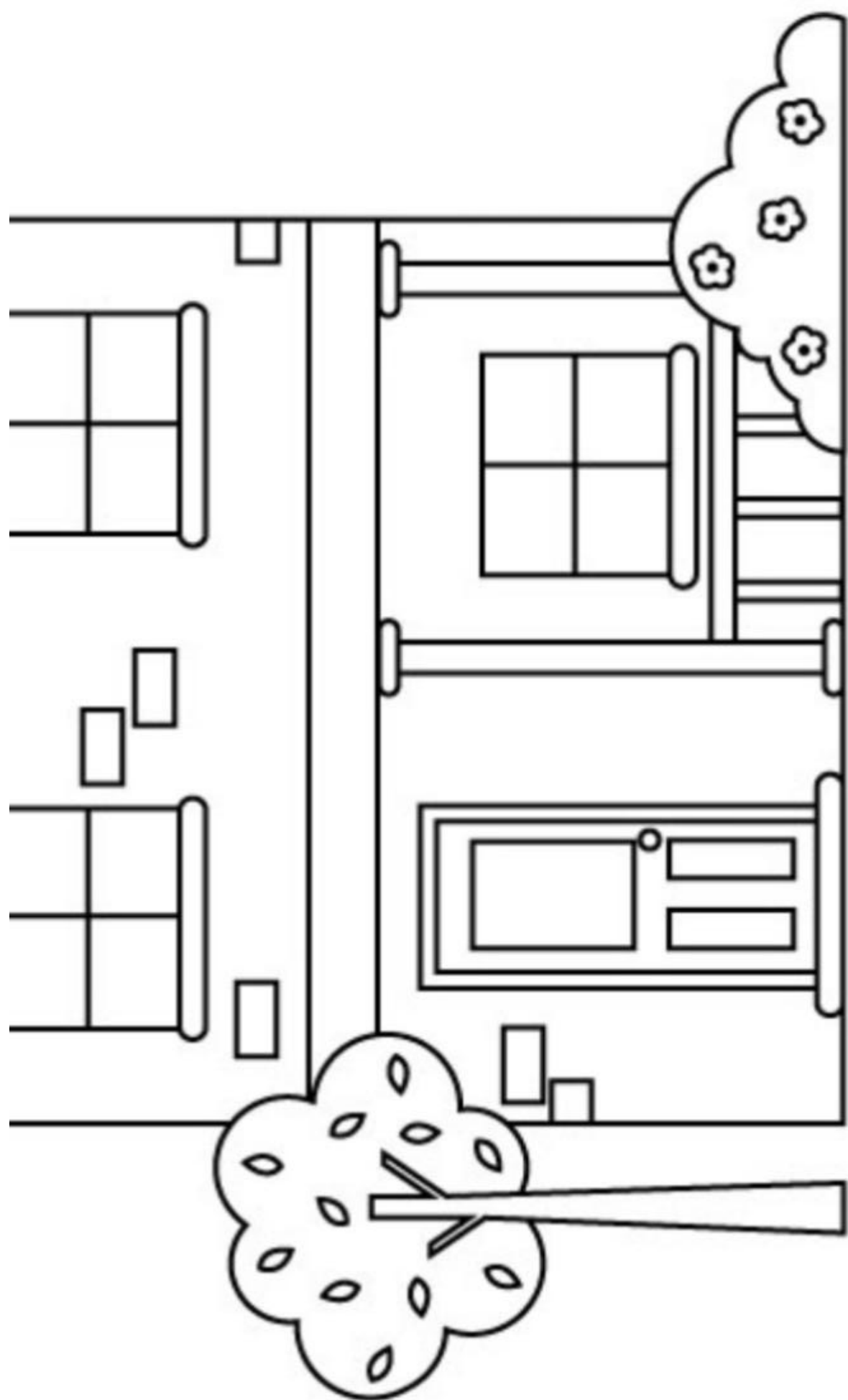

Class 45

Name:

Age:

COOKERY AND PRESERVES continued

- 27. Dilton bake-off showstopper cake – judged on decoration only
- 28. Homemade savoury bread – by machine or handmade
- 29. Homemade sausage rolls – 6 made with a pastry of your choice
- 30. Pot of jam
- 31. Jar of pickled vegetables
- 32. Any homemade fruit-flavoured Gin – 1 bottle

HANDICRAFTS

- 33. Handmade scarf/shawl in any craft
- 34. Item of jewellery
- 35. Picture in any material – maximum size A4
- 36. Get creative with a matchbox
- 37. Decorated tea towel – blank ones £1.30 available from 07740 194929
- 38. Any other craft 'You made it, let's see it'

PHOTOGRAPHY

All entries to be unmounted, unglazed and no larger than 8" x 6" (20cm x 15cm)

- 39. Black and White – any subject
- 40. Up close and personal
- 41. Food glorious food

GROUP DISPLAY

See Rules and Regulations No. 12

- 42. 'Holiday' – to include a cookery item, a flower arrangement and a craft item on a base no larger than 18" x 18" (45cm x 45cm)

UNDER 16s

- 43. Party hat - **class for children aged 5 and under**
- 44. Decorated plant pot
- 45. Colouring picture as provided within the schedule – decorate as you wish
- 46. Photograph 'My favourite animal' – entries to be unmounted, unglazed and no larger than 8" x 6" (20cm x 15cm)
- 47. Any other craft 'You made it, let's see it' - maximum dimension 12"

ALL exhibitors, please refer to the 'Rules and Regulations' page overleaf for further details.

RULES AND REGULATIONS

1. **Open to** residents of Dilton Marsh or members of Dilton Marsh organisations.
2. **One entry per person, per class.** All exhibits displayed at owner's risk. All entrants do so at their own risk and the committee take no responsibility for accidents or injury sustained to an entrant or exhibits during the event.
3. **Time of staging.** All exhibits must be staged in the hall between 9am and 10.30am on the day.
4. **Entry forms** must be returned together with entry fees to 4 Silver Street, Dilton Marsh **by midnight on Tuesday 22nd July.**
No entries will be accepted after that date. Each individual entrant must have their own entry form, including children and group entries.
5. For more entry forms, please either photocopy from this booklet or download and print one from our Facebook page under 'files'.
6. **Adult classes are 30p per class. Under 16's classes are free.** Under 16s can enter other classes if they wish, at cost.
7. **All classes** must be the work of the exhibitor. For clarity in craft categories, please highlight the handmade elements for judging e.g. note if embellishments handmade.
8. **All garden exhibits** must be the property of the exhibitor and have been in their possession for no less than two months prior to the show. Gardeners must not enter exhibits grown in their employer's garden.
9. **All food items** (not in a bottle or jar) should be presented on a paper plate and covered with a film fronted paper bag/cling film/a split bag or cake dome.
10. **Preserves** should be presented in clear jars/bottles with a well-fitting screw top lid/stopper or cellophane (preserves) and labelled with name of preserve and dated. Cover the surface of preserves with a wax disc and avoid air bubbles.
11. **All handicraft & photography entries** must be reasonably recent and should not have been entered into the show before.
12. **Group display** to be constructed by a group of friends/family OR an organisation of two or more people. There are three elements - cookery, flower arranging and craft. If more than one item of any element is included, please write a note highlighting which three items the display should be judged upon.
13. **The judge's decision shall be final.**
14. All prizes will be at the discretion of the committee.
15. The show will be **open to the public** for viewing from 2pm on the day.
16. **Exhibits** must not be removed prior to the prize giving and auction. Items to be included in the auction will be highlighted with a red dot stuck on the entry card at the time of staging.

Prize giving will take place at 3pm. Followed by the auction of produce, *please remember your cash!*

Points Awarded First prize: 4 Second: 3 Third: 2 Highly Commended: 1 point

ENTRY FORM

Please return by midnight on Tuesday, 22nd July 2025.

Admin only,
entrant no.

Each entrant must have their own entry form, including children and each group. Also available to download from our Facebook page under 'files'.

Name of entrant (first name and surname)		
Age, if under 16		
Group name (class 42 only)		
Address:		
Phone number:		
By completing and returning this entry form into the Dilton Marsh Flower & Handicraft Show you are giving your consent and agree that the show committee can hold and where necessary use your information for the organisation and requirements of the show, your information will not be shared with other third-party organisations or used for any other purpose. Full GDPR details available via our Facebook page under 'files'.		
PLEASE CIRCLE THE CLASS NUMBERS THAT YOU ARE ENTERING AND RETAIN A COPY FOR YOUR OWN REFERENCE		
VEGETABLES & FRUIT 1 2 3 4 5 6 7 8 9 10 11 12 13 14		FLOWERS 15 16 17 18 19 20
FLORAL ART 21 22 23 24	COOKERY 25 26 27 28 29 30 31 32	HANDICRAFTS 33 34 35 36 37 38
PHOTOGRAPHY 39 40 41	GROUP DISPLAY 42	UNDER 16's CLASSES 43 44 45 46 47
Classes 1 – 42 cost 30p per class, under 16's classes (43-47) are free		
TOTAL OF PAID ENTRIES		
Number of classes entered with a fee x 30p = £..... cash enclosed		

Please return this form together with cash only

Return to 4 Silver Street, Dilton Marsh, BA13 4DQ

Return by 22nd July, no entries will be accepted after this date.

If you have any questions, please telephone 07876 341865 or email

diltonmarshflowershow@gmail.com



DILTON MARSH
Flower &
Handicraft Show

ENTRY FORM

Please return by midnight on Tuesday, 22nd July 2025.

Admin only,
entrant no.

Each entrant must have their own entry form, including children and each group. Also available to download from our Facebook page under 'files'.

Name of entrant (first name and surname)		
Age, if under 16		
Group name (class 42 only)		
Address:		
Phone number:		
By completing and returning this entry form into the Dilton Marsh Flower & Handicraft Show you are giving your consent and agree that the show committee can hold and where necessary use your information for the organisation and requirements of the show, your information will not be shared with other third-party organisations or used for any other purpose. Full GDPR details available via our Facebook page under 'files'.		
PLEASE CIRCLE THE CLASS NUMBERS THAT YOU ARE ENTERING AND RETAIN A COPY FOR YOUR OWN REFERENCE		
VEGETABLES & FRUIT 1 2 3 4 5 6 7 8 9 10 11 12 13 14		FLOWERS 15 16 17 18 19 20
FLORAL ART 21 22 23 24	COOKERY 25 26 27 28 29 30 31 32	HANDICRAFTS 33 34 35 36 37 38
PHOTOGRAPHY 39 40 41	GROUP DISPLAY 42	UNDER 16's CLASSES 43 44 45 46 47
Classes 1 – 42 cost 30p per class, under 16's classes (43-47) are free		
TOTAL OF PAID ENTRIES		
Number of classes entered with a fee x 30p = £..... cash enclosed		

Please return this form together with cash only

Return to 4 Silver Street, Dilton Marsh, BA13 4DQ

Return by 22nd July, no entries will be accepted after this date.

If you have any questions, please telephone 07876 341865 or email

diltonmarshflowershow@gmail.com



DILTON MARSH
Flower &
Handicraft Show